

Barebone System

HS-3K22



LI-A220W

CM-3K22

SP-5100

KB-C281

MO-W633



Chassis Features

- Compatible with Micro-ATX mainboards
- Competitive cost
- Easy installation and maintenance
- Zinc plated steel
- Simple/Elegant bezel design
- One stop shopping for entry level PC system

Specification

Mainboard	Micro-ATX
Chassis	CM-3K22
Power Supply	PX / PL / PK / PW Series
Drive Bay	5.25" External x 2 ; 3.5" External x 1 + Internal x 2
I/O Ports (Optional)	USB 2.0 Port x 2, Mic Port x 1, Phone jack x 1
LCD Monitor	21.5" (LI-A220W)
Keyboard	Chocolate Keyboard (KB-C281)
Mouse	Wired Optical Mouse (MO-W633)
Speaker	Multimedia Speaker (SP-5100G)

External I/O Module Q Type (Optional)

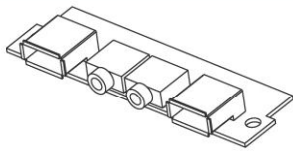

Chassis CM-xx22

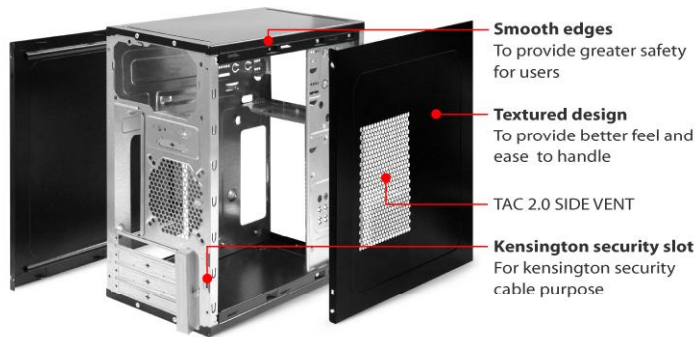

- Smooth edges**
To provide greater safety for users
- Textured design**
To provide better feel and ease to handle
- TAC 2.0 SIDE VENT**
- Kensington security slot**
For kensington security cable purpose

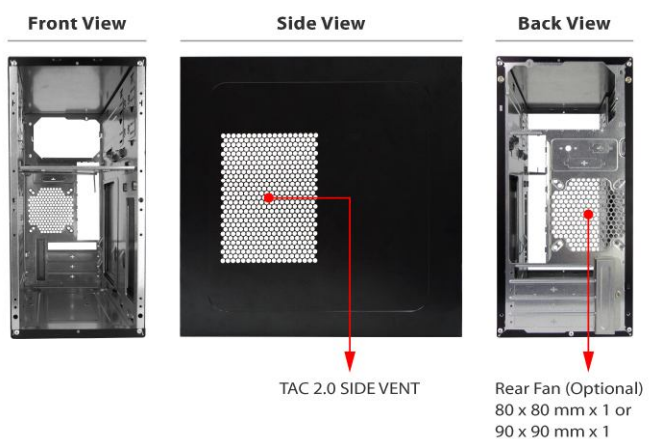

TAC 2.0 SIDE VENT

Rear Fan (Optional)
80 x 80 mm x 1 or
90 x 90 mm x 1

Ø 80 / Ø 90 mm (Optional)

